

STYLE PS1500 POLYURETHANE PISTON SEALS

Totally interchangeable with Style PS1400 PTFE piston seals, Style PS1500 piston seals are molded from tough 60 Shore D durometer polyurethane. During the molding process, a .002" thick band of molybdenum disulfide is molded into the outside diameter of the seal ring for reduced friction. PS1500 piston seals are easily stretched over the piston and recover rapidly with the elimination of the "cold flow" characteristics found in PTFE seals. Piston diameter "I" dimensions are given for pistons without wear rings.

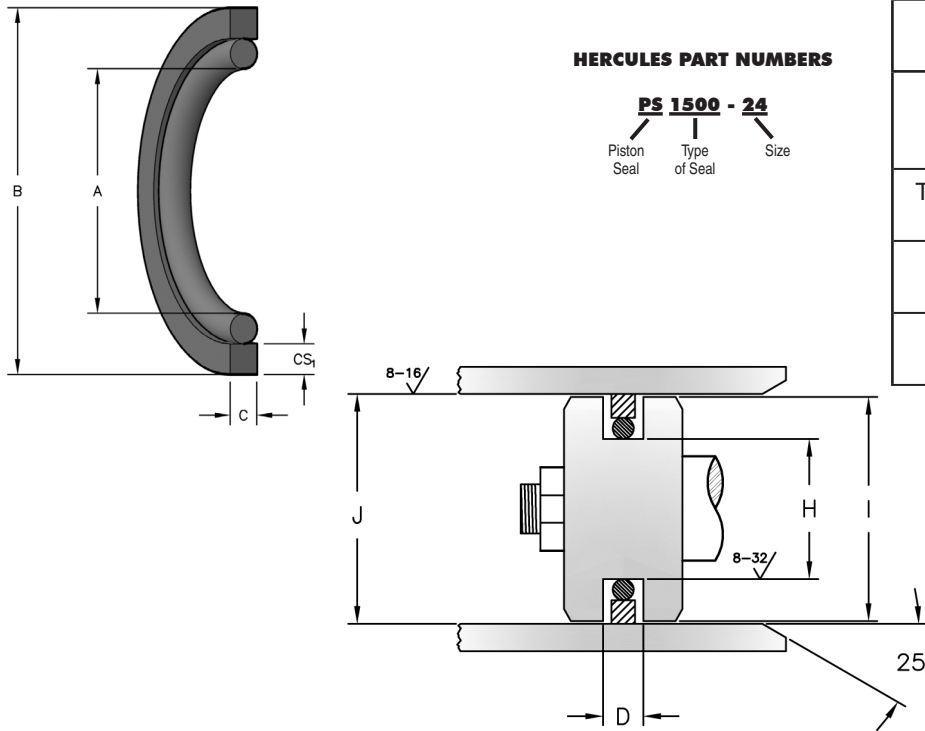

HERCULES PART NUMBERS

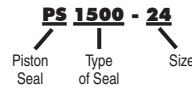

SEAL INFORMATION

MATERIAL	POLYURETHANE SEAL RUBBER ENERGIZER
TEMPERATURE RANGE	-40° TO +200° F
PRESSURE RANGE	0 TO 5,000 PSI
SPEED	3 FT/SEC

Part Number	A Nom. ID	B Nom. OD	C Nom. Ht	D GROOVE WIDTH	H GROOVE DIAMETER	I PISTON DIAMETER	J BORE DIAMETER	C HEIGHT	CS ₁ RING CROSS SECTION	List Price
PS1500-20A	.99	1-1/4	.121	.129 ^{+0.002} / _{+0.000}	.990 ^{+0.002} / _{+0.000}	1.247 ±.001	1.250 ^{+0.002} / _{+0.000}	.121 ±.002	.062 ±.002	\$48.37
PS1500-24	1.241	1-1/2	.07	.083 ^{+0.002} / _{+0.000}	1.241 ^{+0.002} / _{+0.000}	1.497 ±.001	1.500 ^{+0.002} / _{+0.000}	.070 ±.005	.070 ±.005	5.03
PS1500-28	1.36	1-3/4	.109	.122 ^{+0.002} / _{+0.000}	1.360 ^{+0.002} / _{+0.000}	1.747 ±.001	1.750 ^{+0.002} / _{+0.000}	.109 ±.005	.109 ±.005	5.24
PS1500-32	1.606	2	.115	.130 ^{+0.002} / _{+0.000}	1.606 ^{+0.002} / _{+0.000}	1.996 ±.001	2.000 ^{+0.002} / _{+0.000}	.115 ±.005	.115 ±.005	5.44
PS1500-36	1.856	2-1/4	.115	.130 ^{+0.002} / _{+0.000}	1.856 ^{+0.002} / _{+0.000}	2.246 ±.001	2.250 ^{+0.002} / _{+0.000}	.115 ±.005	.115 ±.005	5.59
PS1500-38	1.981	2-3/8	.115	.130 ^{+0.002} / _{+0.000}	1.981 ^{+0.002} / _{+0.000}	2.371 ±.001	2.375 ^{+0.002} / _{+0.000}	.115 ±.005	.115 ±.005	5.63
PS1500-40	2.106	2-1/2	.115	.130 ^{+0.002} / _{+0.000}	2.106 ^{+0.002} / _{+0.000}	2.496 ±.001	2.500 ^{+0.002} / _{+0.000}	.115 ±.005	.115 ±.005	5.66
PS1500-44	2.356	2-3/4	.115	.130 ^{+0.002} / _{+0.000}	2.356 ^{+0.002} / _{+0.000}	2.746 ±.001	2.750 ^{+0.002} / _{+0.000}	.115 ±.005	.115 ±.005	5.74
PS1500-48	2.606	3	.115	.130 ^{+0.002} / _{+0.000}	2.606 ^{+0.002} / _{+0.000}	2.996 ±.001	3.000 ^{+0.002} / _{+0.000}	.115 ±.005	.115 ±.005	5.91
PS1500-52	2.856	3-1/4	.115	.130 ^{+0.002} / _{+0.000}	2.856 ^{+0.002} / _{+0.000}	3.246 ±.001	3.250 ^{+0.002} / _{+0.000}	.115 ±.005	.115 ±.005	6.03
PS1500-54	2.981	3-3/8	.115	.130 ^{+0.002} / _{+0.000}	2.981 ^{+0.002} / _{+0.000}	3.371 ±.001	3.375 ^{+0.002} / _{+0.000}	.115 ±.005	.115 ±.005	8.85
PS1500-56	3.106	3-1/2	.115	.130 ^{+0.002} / _{+0.000}	3.106 ^{+0.002} / _{+0.000}	3.496 ±.001	3.500 ^{+0.002} / _{+0.000}	.115 ±.005	.115 ±.005	6.22
PS1500-60	3.356	3-3/4	.115	.130 ^{+0.002} / _{+0.000}	3.356 ^{+0.002} / _{+0.000}	3.746 ±.001	3.750 ^{+0.002} / _{+0.000}	.115 ±.005	.115 ±.005	6.35

STYLE PS1500 POLYURETHANE PISTON SEALS

Part Number	A Nom. ID	B Nom. OD	C Nom. Ht	D GROOVE WIDTH	H GROOVE DIAMETER	I PISTON DIAMETER	J BORE DIAMETER	C HEIGHT	CS ₁ RING CROSS SECTION	List Price
PS1500-64	3.606	4	.115	.130 ^{+0.002} / _{+0.000}	3.606 ^{+0.002} / _{+0.000}	3.996 ±.001	4.000 ^{+0.002} / _{+0.000}	.115 ±.005	.115 ±.005	6.78
PS1500-68	3.856	4-1/4	.115	.130 ^{+0.002} / _{+0.000}	3.856 ^{+0.002} / _{+0.000}	4.246 ±.001	4.250 ^{+0.002} / _{+0.000}	.115 ±.005	.115 ±.005	6.97
PS1500-72	4.106	4-1/2	.115	.130 ^{+0.002} / _{+0.000}	4.106 ^{+0.002} / _{+0.000}	4.496 ±.001	4.500 ^{+0.002} / _{+0.000}	.115 ±.005	.115 ±.005	7.69
PS1500-76	4.356	4-3/4	.115	.130 ^{+0.002} / _{+0.000}	4.356 ^{+0.002} / _{+0.000}	4.746 ±.001	4.750 ^{+0.002} / _{+0.000}	.115 ±.005	.115 ±.005	7.94
PS1500-80	4.606	5	.115	.130 ^{+0.002} / _{+0.000}	4.606 ^{+0.002} / _{+0.000}	4.996 ±.001	5.000 ^{+0.002} / _{+0.000}	.115 ±.005	.115 ±.005	8.51
PS1500-84	4.856	5-1/4	.115	.130 ^{+0.002} / _{+0.000}	4.856 ^{+0.002} / _{+0.000}	5.246 ±.001	5.250 ^{+0.002} / _{+0.000}	.115 ±.005	.115 ±.005	9.02
PS1500-88	5.106	5-1/2	.115	.130 ^{+0.002} / _{+0.000}	5.106 ^{+0.002} / _{+0.000}	5.496 ±.001	5.500 ^{+0.002} / _{+0.000}	.115 ±.005	.115 ±.005	9.49
PS1500-92	5.232	5-3/4	.143	.159 ^{+0.002} / _{+0.000}	5.232 ^{+0.002} / _{+0.000}	5.746 ±.001	5.750 ^{+0.002} / _{+0.000}	.143 ±.005	.143 ±.005	10.51
PS1500-96	5.482	6	.143	.159 ^{+0.002} / _{+0.000}	5.482 ^{+0.002} / _{+0.000}	5.996 ±.001	6.000 ^{+0.002} / _{+0.000}	.143 ±.005	.143 ±.005	13.48
PS1500-104	5.982	6-1/2	.143	.159 ^{+0.002} / _{+0.000}	5.982 ^{+0.002} / _{+0.000}	6.496 ±.001	6.500 ^{+0.002} / _{+0.000}	.143 ±.005	.143 ±.005	14.15
PS1500-112	6.482	7	.143	.159 ^{+0.002} / _{+0.000}	6.482 ^{+0.002} / _{+0.000}	6.996 ±.001	7.000 ^{+0.002} / _{+0.000}	.143 ±.005	.143 ±.005	14.96
PS1500-136	7.982	8-1/2	.143	.159 ^{+0.002} / _{+0.000}	7.982 ^{+0.002} / _{+0.000}	8.494 ±.001	8.500 ^{+0.002} / _{+0.000}	.143 ±.005	.143 ±.005	16.99