

# **HPU SUCTION & RETURN CONNECTIONS**



**866-FLANGES | 513.527.4444 | Fax 513.527.4449**  
sales@anchorfluidpower.com | anchorfluidpower.com

# Hose Barb to SAE Flange Head



- Suction to 400 psi max
- Carbon steel natural finish
- Material certificates available upon request
- Flange head manufactured to SAE J518-1

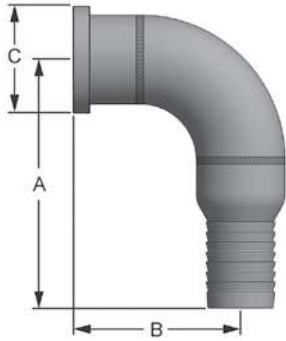

90° HOSE BARB TO SAE FLANGE HEAD							
	HOSE SIZE	FLANGE SIZE	A	B	C	ID	SPLIT FLANGE
20HB-20SF90	1.25	1.25	4.64	3.13	2.00	1.03	20SFO
24HB-24SF90	1.50	1.50	5.00	3.50	2.38	1.28	24SFO
32HB-32SF90	2.00	2.00	6.19	4.25	2.81	1.75	32SFO
40HB-40SF90	2.50	2.50	7.50	5.50	3.31	2.17	40SFO
48HB-48SF90	3.00	3.00	8.75	6.38	4.00	2.72	48SFO
64HB-64SF90	4.00	4.00	10.75	7.75	5.00	3.69	64SFO

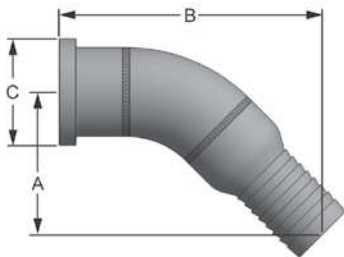

45° HOSE BARB TO SAE FLANGE HEAD							
	HOSE SIZE	FLANGE SIZE	A	B	C	ID	SPLIT FLANGE
20HB-20SF45	1.25	1.25	2.66	4.91	2.00	1.03	20SFO
24HB-24SF45	1.50	1.50	2.74	5.12	2.38	1.28	24SFO
32HB-32SF45	2.00	2.00	3.23	5.85	2.81	1.75	32SFO
40HB-40SF45	2.50	2.50	3.89	7.39	3.31	2.17	40SFO
48HB-48SF45	3.00	3.00	4.42	8.30	4.00	2.72	48SFO
64HB-64SF45	4.00	4.00	5.13	9.38	5.00	3.69	64SFO

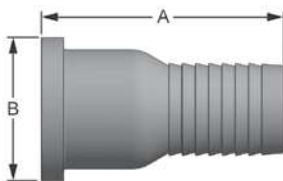

STRAIGHT HOSE BARB TO SAE FLANGE HEAD						
	HOSE SIZE	FLANGE SIZE	A	B	ID	SPLIT FLANGE
20HB-20SF	1.25	1.25	3.39	2.00	1.03	20SFO
24HB-24SF	1.50	1.50	3.50	2.38	1.28	24SFO
32HB-32SF	2.00	2.00	3.93	2.81	1.75	32SFO
40HB-40SF	2.50	2.50	4.63	3.31	2.17	40SFO
48HB-48SF	3.00	3.00	5.19	4.00	2.72	48SFO
64HB-64SF	4.00	4.00	5.83	5.00	3.69	64SFO

† Optional Split Flange sold separately

## SAE Thread to Tank Coupling



- Suction to 400 psi max
- Buna seals standard / Viton optional
- Carbon steel natural finish
- 90° & 45° SAE thread with adjustable nut
- Material certificates available upon request
- SAE threads manufactured to J1926

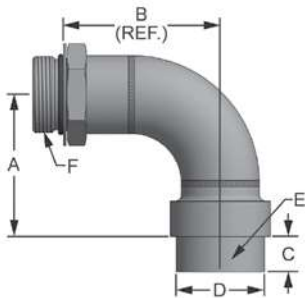

90° SAE THREAD TO TANK COUPLING										
	LINE SIZE	TANK PILOT	A	B (REF.)	C	D	E (INTERNAL THREAD)	F	ID	BALL VALVE
20NPT-20SAE90	1.25	1.25	3.01	3.28	0.75	1.88	1 1/4-11.5	1 5/8-12	1.08	LV2BS#20-2T-MH
*24NPT-24SAE90	1.50	1.50	3.38	3.65	0.75	2.13	1 1/2-11.5	1 7/8-12	1.32	LV2BS#24-2T-MH
*32NPT-32SAE90	2.00	2.00	4.13	4.40	0.88	2.63	2-11.5	2 1/2-12	1.58	LV2BS#32-2T-MH
*40NPT-40SAE90	2.50	2.50	5.38	5.23	1.00	3.25	2 1/2-8	3-12	2.09	LV2BS#40-2T-MH
*48NPT-48SAE90	3.00	3.00	6.00	6.15	1.00	4.00	3-8	3 1/2-12	2.48	LV2BS#48-2T-MH
*64NPT-64SAE90	4.00	4.00	8.00	7.65	1.00	5.00	4-8	4 1/2-12	3.94	LV2BS#64-2T-MH

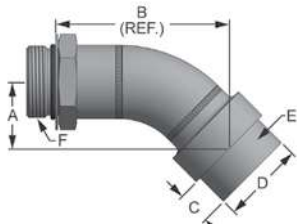

45° SAE THREAD TO TANK COUPLING										
	LINE SIZE	TANK PILOT	A	B (REF.)	C	D	E (INTERNAL THREAD)	F	ID	BALL VALVE
20NPT-20SAE45	1.25	1.25	1.51	3.96	0.75	1.88	1 1/4-11.5	1 5/8-12	1.08	LV2BS#20-2T-MH
*24NPT-24SAE45	1.50	1.50	1.60	4.17	0.75	2.13	1 1/2-11.5	1 7/8-12	1.32	LV2BS#24-2T-MH
*32NPT-32SAE45	2.00	2.00	1.77	4.60	0.88	2.63	2-11.5	2 1/2-12	1.58	LV2BS#32-2T-MH
*40NPT-40SAE45	2.50	2.50	2.39	5.68	1.00	3.25	2 1/2-8	3-12	2.09	LV2BS#40-2T-MH
*48NPT-48SAE45	3.00	3.00	2.48	6.18	1.00	4.00	3-8	3 1/2-12	2.48	LV2BS#48-2T-MH
*64NPT-64SAE45	4.00	4.00	3.18	7.39	1.00	5.00	4-8	4 1/2-12	3.94	LV2BS#64-2T-MH

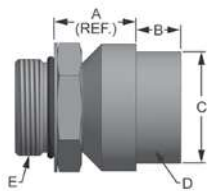

STRAIGHT SAE THREAD TO TANK COUPLING										
	LINE SIZE	TANK PILOT	A (REF.)	B	C	D (INTERNAL THREAD)	E	ID	BALL VALVE	
20NPT-20SAE	1.25	1.25	1.38	0.75	1.88	1 1/4-11.5	1 5/8-12	1.08	LV2BS#20-2T-MH	
*24NPT-24SAE	1.50	1.50	1.51	0.75	2.13	1 1/2-11.5	1 7/8-12	1.32	LV2BS#24-2T-MH	
*32NPT-32SAE	2.00	2.00	1.51	0.88	2.63	2-11.5	2 1/2-12	1.58	LV2BS#32-2T-MH	
*40NPT-40SAE	2.50	2.50	1.58	1.00	3.25	2 1/2-8	3-12	2.09	LV2BS#40-2T-MH	
*48NPT-48SAE	3.00	3.00	1.65	1.00	4.00	3-8	3 1/2-12	2.48	LV2BS#48-2T-MH	
*64NPT-64SAE	4.00	4.00	1.65	1.00	5.00	4-8	4 1/2-12	3.94	LV2BS#64-2T-MH	

\* Uses Adjustable Spanner

† Optional Ball Valve sold separately



# SAE Thread to Flange Head



- Suction to 400 psi max
- Buna seals standard / Viton optional
- Carbon steel natural finish
- 90° & 45° SAE thread with adjustable nut
- Material certificates available upon request
- SAE threads manufactured to J1926

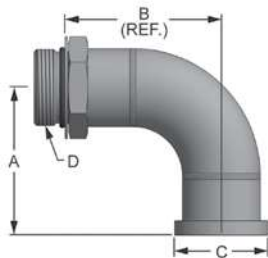

90° SAE THREAD TO FLANGE HEAD										
	LINE SIZE	FLANGE SIZE	A	B (REF.)	C	D	ID	BALL VALVE	SPLIT FLANGE	
	20SF-20SAE90	1.25	1.25	3.13	3.28	2.00	1 5/8-12	1.08	LV2BS#20-2T-MH	20SFO
	*24SF-24SAE90	1.50	1.50	3.50	3.65	2.38	1 7/8-12	1.32	LV2BS#24-2T-MH	24SFO
	*32SF-32SAE90	2.00	2.00	4.25	4.40	2.81	2 1/2-12	1.58	LV2BS#32-2T-MH	32SFO
	*40SF-40SAE90	2.50	2.50	5.50	5.23	3.31	3-12	2.09	LV2BS#40-2T-MH	40SFO
	*48SF-48SAE90	3.00	3.00	6.38	6.15	4.00	3 1/2-12	2.48	LV2BS#48-2T-MH	48SFO
	*64SF-64SAE90	4.00	4.00	7.75	7.65	5.00	4 1/2-12	3.83	LV2BS#64-2T-MH	64SFO

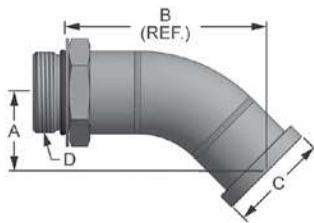

45° SAE THREAD TO FLANGE HEAD										
	LINE SIZE	FLANGE SIZE	A	B (REF.)	C	D	ID	BALL VALVE	SPLIT FLANGE	
	20SF-20SAE45	1.25	1.25	1.59	4.00	2.00	1 5/8-12	1.08	LV2BS#20-2T-MH	20SFO
	*24SF-24SAE45	1.50	1.50	1.68	4.20	2.38	1 7/8-12	1.32	LV2BS#24-2T-MH	24SFO
	*32SF-32SAE45	2.00	2.00	1.86	4.64	2.81	2 1/2-12	1.58	LV2BS#32-2T-MH	32SFO
	*40SF-40SAE45	2.50	2.50	2.48	5.68	3.31	3-12	2.09	LV2BS#40-2T-MH	40SFO
	*48SF-48SAE45	3.00	3.00	2.74	6.39	4.00	3 1/2-12	2.48	LV2BS#48-2T-MH	48SFO
	*64SF-64SAE45	4.00	4.00	3.00	7.16	5.00	4 1/2-12	3.83	LV2BS#64-2T-MH	64SFO

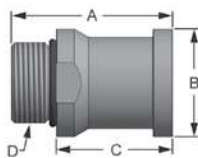

STRAIGHT SAE THREAD TO FLANGE HEAD										
	LINE SIZE	FLANGE SIZE	A	B	C	D	ID	BALL VALVE	SPLIT FLANGE	
	**302-20-20	1.25	1.25	3.13	2.00	2.41	1 5/8-12	1.08	LV2BS#20-2T-MH	20SFO
	**302-24-24	1.50	1.50	3.14	2.38	2.42	1 7/8-12	1.32	LV2BS#24-2T-MH	24SFO
	**302-32-32	2.00	2.00	3.63	2.81	2.91	2 1/2-12	1.57	LV2BS#32-2T-MH	32SFO
	**302-40-40	2.50	2.50	4.23	3.31	3.40	3-12	2.09	LV2BS#40-2T-MH	40SFO
	**302-48-48	3.00	3.00	4.50	4.00	3.52	3 1/2-12	2.48	LV2BS#48-2T-MH	48SFO
	**302-64-64	4.00	4.00	4.14	5.00	3.45	4 1/2-12	3.94	LV2BS#64-2T-MH	64SFO

\* Uses Adjustable Spanner  
 \*\* 302 Series Silver Trivalent Plated  
 † Optional Ball Valve and Split Flange sold separately

## Hose Barb to SAE Thread

- Suction to 400 PSI max
- Buna seals standard / Viton optional
- Carbon steel natural finish
- 90° & 45° SAE thread with adjustable nut
- Material certificates available upon request
- SAE threads manufactured to J1926

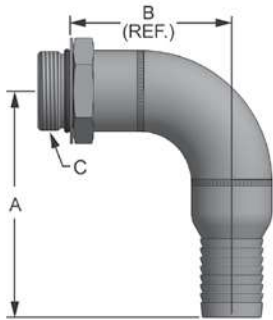

90° HOSE BARB TO SAE THREAD							
	HOSE SIZE	THREAD SIZE	A	B (REF.)	C	ID	BALL VALVE
20HB-20SAE90	1.25	1.25	4.64	3.28	1 5/8-12	1.03	LV2BS#20-2T-MH
*24HB-24SAE90	1.50	1.50	5.00	3.65	1 7/8-12	1.28	LV2BS#24-2T-MH
*32HB-32SAE90	2.00	2.00	6.19	4.40	2 1/2-12	1.58	LV2BS#32-2T-MH
*40HB-40SAE90	2.50	2.50	7.50	5.23	3-12	2.09	LV2BS#40-2T-MH
*48HB-48SAE90	3.00	3.00	8.75	6.15	3 1/2-12	2.48	LV2BS#48-2T-MH
*64HB-64SAE90	4.00	4.00	10.75	7.65	4 1/2-12	3.69	LV2BS#64-2T-MH

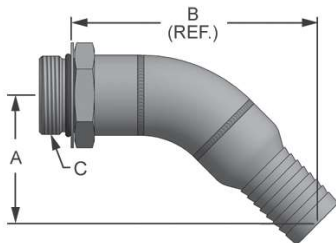

45° HOSE BARB TO SAE THREAD							
	HOSE SIZE	THREAD SIZE	A	B (REF.)	C	ID	BALL VALVE
20HB-20SAE45	1.25	1.25	2.66	5.11	1 5/8-12	1.03	LV2BS#20-2T-MH
*24HB-24SAE45	1.50	1.50	2.74	5.31	1 7/8-12	1.28	LV2BS#24-2T-MH
*32HB-32SAE45	2.00	2.00	3.23	6.05	2 1/2-12	1.58	LV2BS#32-2T-MH
*40HB-40SAE45	2.50	2.50	3.89	7.18	3-12	2.09	LV2BS#40-2T-MH
*48HB-48SAE45	3.00	3.00	4.42	8.13	3 1/2-12	2.48	LV2BS#48-2T-MH
*64HB-64SAE45	4.00	4.00	5.13	9.34	4 1/2-12	3.69	LV2BS#64-2T-MH

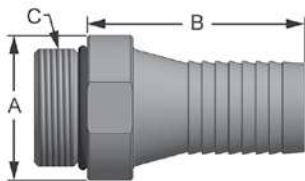

STRAIGHT HOSE BARB TO SAE THREAD							
	HOSE SIZE	THREAD SIZE	A	B	C	ID	BALL VALVE
20HB-20SAE	1.25	1.25	2.00	3.01	1 5/8-12	1.03	LV2BS#20-2T-MH
24HB-24SAE	1.50	1.50	2.50	3.01	1 7/8-12	1.28	LV2BS#24-2T-MH
32HB-32SAE	2.00	2.00	3.25	3.45	2 1/2-12	1.58	LV2BS#32-2T-MH
40HB-40SAE	2.50	2.50	3.75	4.01	3-12	2.09	LV2BS#40-2T-MH
48HB-48SAE	3.00	3.00	4.50	4.63	3 1/2-12	2.48	LV2BS#48-2T-MH
64HB-64SAE	4.00	4.00	5.50	5.13	4 1/2-12	3.69	LV2BS#64-2T-MH

\* Uses Adjustable Spanner  
 † Optional Ball Valve sold separately



# Suction and Return Line Valves



- All stainless steel construction
- Locking handle standard
- SAE threads manufactured to J1926
- Bracket designed to support limit switch or proximity sensor
- Prox is M12 4-Pin connector, normally open, and VDC only
- Limit can be wired VDC or VAC and normally open or normally closed
- Both limit and prox have IP67 rating

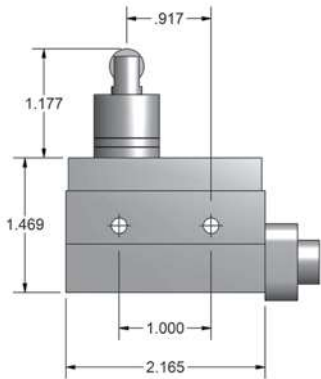
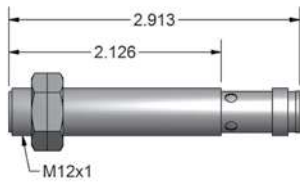
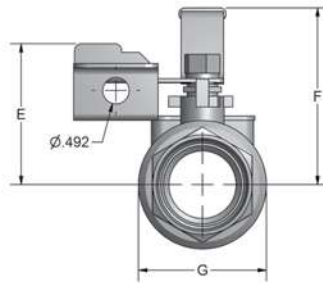
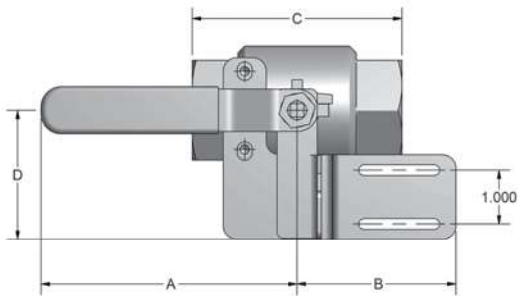

LV2B SERIES - SAE									
SIZE	PSI MAX	A	B	C	D	E	F	G	ID
1"	1000	5.00	2.90	3.60	2.45	2.50	3.25	2.07	0.98
1-1/4"	1000	5.15	2.95	3.95	2.45	2.85	3.10	2.36	1.26
1-1/2"	1000	6.10	2.96	4.24	2.38	3.28	3.97	2.77	1.50
2"	1000	6.10	2.91	4.88	2.38	3.53	4.34	3.50	1.97
2-1/2"	1000	9.06	2.86	6.30	2.84	4.18	5.20	4.53	2.56
3"	1000	9.06	2.91	7.26	3.07	4.70	5.71	5.35	3.15
4"	500	13.00	2.90	8.80	3.11	6.10	7.11	7.02	3.93

\*For Technical and Material info refer to page 44

**LV2BS#16 - 2T - MHS**

- B:** Bracket only, No Limit Switch or Proximity Sensor
- S:** Bracket and Limit Switch
- P:** Bracket and Proximity Sensor
- Omit:** No bracket, Limit Switch, or Proximity Sensor

**THREAD SIZE**