

A10V SWASHPLATE AXIAL PISTON PUMPS

TECHNICAL SPECIFICATIONS

- SWASHPLATE AXIAL PISTON PUMP
- GOOD SUCTION CHARACTERISTICS
- COMPACT, LIGHTWEIGHT, LOW NOISE
- LONG SERVICE LIFE, HIGH PRECISION BEARINGS
- AXIAL AND RADIAL LOAD CAPACITY



MAXIMUM OPERATING PRESSURE

NOMINAL: 4060 PSI (280 BAR)  
 INTERMITTENT: 4560 PSI (315 BAR)  
 PEAK: 5075 PSI (350 BAR)  
 MAXIMUM CASE DRAIN PRESSURE: 29 PSI (2 BAR)  
 SUCCION PRESSURE RANGE: 11.6 - 435 PSI (0.8 - 30 BAR) ABSOLUTE

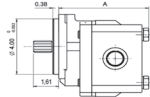
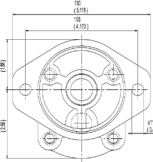

FEATURES

- PRESSURE COMPENSATOR WITH LOAD SENSE CONTROL (DFR)
- VOLUME STOP
- CLOCKWISE ROTATION
- SIDE PORTS WITH CODE 61 FLANGES
- BUNA SEALS

ALSO AVAILABLE

- MANY CONTROLS SUCH AS: REMOTE COMPENSATOR (DRG) AND COMPENSATOR WITH HORSEPOWER LIMITER (DFLR)
- COUNTERCLOCKWISE ROTATION
- END PORTS WITH CODE 61 OR 62 FLANGES
- VITON SEALS
- OTHER MOUNTING FLANGES AND SHAFTS

DISPLACEMENT in <sup>3</sup> (cm <sup>3</sup> ) / rev.	GPM @ 1800 RPM	MAX RPM	MOUNTING FLANGE	PORTS CODE FLANGE 61	DRAIN PORT	SHAFT	PART NO
1.1 (18)	8.5	3300	SAE-A 2 BOLT	INLET: 1" OUTLET: 3/4"	SAE-06	3/4" KEY	A10VS0-18-DFR-31-R-P-K-C62N00
						3/4-SPLINE	A10VS0-18-DFR-31-R-P-S-C62N00
1.71 (28)	13	3000	SAE-B 2 BOLT	INLET: 1 1/4" OUTLET: 1"	SAE-08	7/8" KEY	A10VS0-28-DFR-31-R-P-K-C62N00
						7/8" SPLINE	A10VS0-28-DFR-31-R-P-S-C62N00
2.75 (45)	21	2600		INLET: 1 1/2" OUTLET: 1"	SAE-10	1" KEY	A10VS0-45-DFR-31-R-P-K-C62N00
						1" SPLINE	A10VS0-45-DFR-31-R-P-S-C62N00
4.33 (71)	33.5	2200	SAE-C 2 BOLT	INLET: 2" OUTLET: 1"	SAE-10	1 1/4" KEY	A10VS0-71-DFR-31-R-P-K-C62N00
						1 1/4" SPLINE	A10VS0-71-DFR-31-R-P-S-C62N00
6.10 (100)	47	2000		INLET: 2 1/2" OUTLET: 1 1/4"	SAE-12	1 1/2" KEY	A10VS0-100-DFR-31-R-P-K-C62N00
						1 1/2" SPLINE	A10VS0-100-DFR-31-R-P-S-C62N00
8.54 (140)	66.5	1800	SAE-D 4 BOLT	INLET: 2 1/2" OUTLET: 1 1/4"	SAE-12	1 3/4" KEY	A10VS0-140-DFR-31-R-P-K-C62N00
						1 3/4" SPLINE	A10VS0-140-DFR-31-R-P-S-C62N00