

# STYLE MSWN SNAP-IN WIPERS

This medium duty wiper is molded in nitrile rubber.

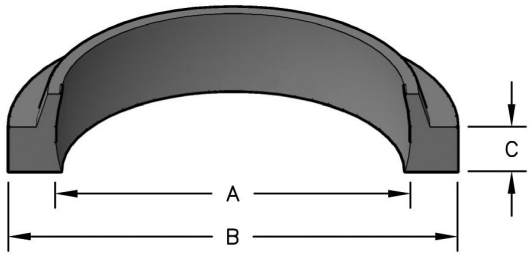

### HERCULES PART NUMBERS

**MSWN - 18 X 26 X 5**  
 Type of Seal    Inside Diameter    Outside Diameter    Height

SEAL INFORMATION	
MATERIAL	NITRILE
TEMPERATURE RANGE	-22° TO +212° F
SPEED	3 FT/SEC

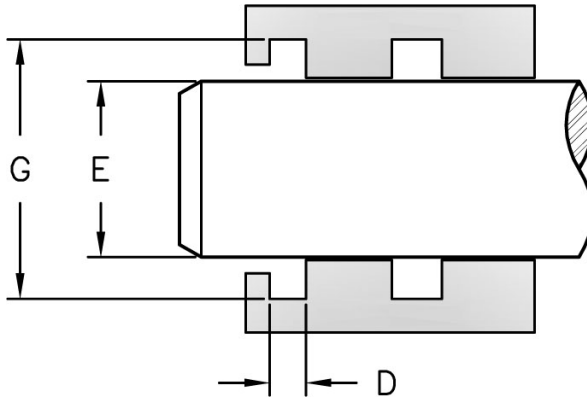

WIPER RINGS

Part Number	A Nom. ID	B Nom. OD	C Nom. Ht	D GROOVE WIDTH	E ROD DIAMETER	G HOUSING DIAMETER	List Price
MSWN-18X26X5	18	26	5	5.30 +0.20 +0.00	18.00 -0.016 -0.059	26.00 +0.13 +0.00	\$2.84
MSWN-20X28X4	20	28	4	4.10 +0.20 +0.00	20.00 -0.020 -0.072	28.00 +0.13 +0.00	5.63
MSWN-28X36X4	28	36	4	4.10 +0.20 +0.00	28.00 -0.020 -0.072	36.00 +0.16 +0.00	5.94
MSWN-30X42X6	30	42	6	6.30 +0.20 +0.00	30.00 -0.020 -0.072	42.00 +0.16 +0.00	4.57
MSWN-32X40X5	32	40	5	5.00 +0.20 +0.00	32.00 -0.025 -0.087	40.00 +0.16 +0.00	8.61
MSWN-32X44X6	32	44	6	6.30 +0.20 +0.00	32.00 -0.025 -0.087	44.00 +0.16 +0.00	4.57
MSWN-35X47X6	35	47	6	6.30 +0.20 +0.00	35.00 -0.025 -0.087	47.00 +0.16 +0.00	8.31
MSWN-36X48X6	36	48	6	6.30 +0.20 +0.00	36.00 -0.025 -0.087	48.00 +0.16 +0.00	5.63
MSWN-38X46X5	38	46	5	5.30 +0.20 +0.00	38.00 -0.025 -0.087	46.00 +0.16 +0.00	15.26
MSWN-40X48X3	40	48	3	3.10 +0.20 +0.00	40.00 -0.025 -0.087	48.00 +0.16 +0.00	13.08
MSWN-40X49X3	40	49	3	3.10 +0.20 +0.00	40.00 -0.025 -0.087	49.00 +0.16 +0.00	14.93
MSWN-40X52X6	40	52	6	6.30 +0.20 +0.00	40.00 -0.025 -0.087	52.00 +0.19 +0.00	4.66
MSWN-45X57X4.8	45	57	4.8	5.00 +0.20 +0.00	45.00 -0.025 -0.087	57.00 +0.19 +0.00	16.80
MSWN-45X57X6	45	57	6	6.30 +0.20 +0.00	45.00 -0.025 -0.087	57.00 +0.19 +0.00	5.63
MSWN-50X62X5	50	62	5	5.30 +0.20 +0.00	50.00 -0.025 -0.087	62.00 +0.19 +0.00	11.81
MSWN-50X62X6	50	62	6	6.30 +0.20 +0.00	50.00 -0.025 -0.087	62.00 +0.19 +0.00	5.02
MSWN-55X65X5	55	65	5	5.30 +0.20 +0.00	55.00 -0.030 -0.104	65.00 +0.19 +0.00	5.30

# STYLE MSWN SNAP-IN WIPERS

Part Number	A Nom. ID	B Nom. OD	C Nom. Ht	D GROOVE WIDTH	E ROD DIAMETER	G HOUSING DIAMETER	List Price
MSWN-55X67X6	55	67	6	6.30 +0.20 +0.00	55.00 -0.030 -0.104	67.00 +0.19 +0.00	9.41
MSWN-56X66X5	56	66	5	5.30 +0.20 +0.00	56.00 -0.030 -0.104	66.00 +0.19 +0.00	4.57
MSWN-60X68.6X5	60	68.6	5	5.30 +0.20 +0.00	60.00	68.60 +0.20 +0.00	6.69
MSWN-60X70X5	60	70	5	5.30 +0.20 +0.00	60.00 -0.030 -0.104	70.00 +0.19 +0.00	6.56
MSWN-63X73X5	63	73	5	5.30 +0.20 +0.00	63.00 -0.030 -0.104	73.00 +0.19 +0.00	5.63
MSWN-65X75X5	65	75	5	5.30 +0.20 +0.00	65.00 -0.030 -0.104	75.00 +0.19 +0.00	7.20
MSWN-70X80X5	70	80	5	5.30 +0.20 +0.00	70.00 -0.030 -0.104	80.00 +0.19 +0.00	6.43
MSWN-70X82X6	70	82	6	6.30 +0.20 +0.00	70.00 -0.030 -0.104	82.00 +0.22 +0.00	8.62
MSWN-70X82X7	70	82	7	7.10 +0.20 +0.00	70.00 -0.030 -0.104	82.00 +0.22 +0.00	6.43
MSWN-75X83X5	75	83	5	5.30 +0.20 +0.00	75.00 -0.030 -0.104	83.00 +0.22 +0.00	7.32
MSWN-75X87X3.8	75	87	3.8	4.00 +0.20 +0.00	75.00 -0.030 -0.104	87.00 +0.22 +0.00	19.80
MSWN-80X90X6	80	90	6	6.30 +0.20 +0.00	80.00 -0.030 -0.104	90.00 +0.22 +0.00	11.48
MSWN-85X97X7	85	97	7	7.10 +0.20 +0.00	85.00 -0.036 -0.123	97.00 +0.22 +0.00	8.00
MSWN-90X102X7	90	102	7	7.10 +0.20 +0.00	90.00 -0.036 -0.123	102.00 +0.22 +0.00	7.97
MSWN-100X112X7	100	112	7	7.10 +0.20 +0.00	100.00 -0.036 -0.123	112.00 +0.22 +0.00	9.10
MSWN-105X117X7	105	117	7	7.10 +0.20 +0.00	105.00 -0.036 -0.123	117.00 +0.22 +0.00	22.24
MSWN-110X122X7	110	122	7	7.10 +0.20 +0.00	110.00 -0.036 -0.123	122.00 +0.25 +0.00	11.29
MSWN-140X152X7	140	152	7	7.10 +0.20 +0.00	140.00 -0.043 -0.143	152.00 +0.25 +0.00	14.73
MSWN-140X155X10	140	155	10	10.20 +0.20 +0.00	140.00 -0.043 -0.143	155.00 +0.25 +0.00	14.18
MSWN-160X175X10	160	175	10	10.20 +0.20 +0.00	160.00 -0.043 -0.143	175.00 +0.25 +0.00	15.03
MSWN-200X220X10	200	220	10	10.20 +0.20 +0.00	200.00 -0.050 -0.165	220.00 +0.29 +0.00	16.12
MSWN-240X260X10	240	260	10	10.20 +0.20 +0.00	240.00 -0.050 -0.165	260.00 +0.32 +0.00	17.92

WIPER RINGS

Seal color may vary. Special order sizes are available. Sizes not shown and out of stock items can also be ordered for next day delivery through Seals On Demand, our custom seal program. Please call your regional sales team for assistance.