

STYLE PS1600 GLASS FILLED PTFE PISTON SEALS

NOTE: Piston diameter "I" dimensions are given for pistons without wear rings.

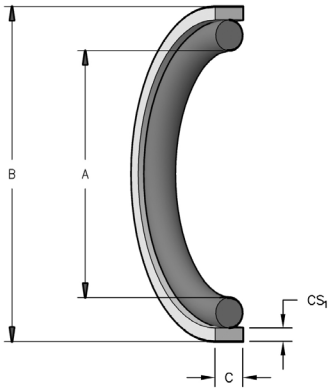

HERCULES PART NUMBERS

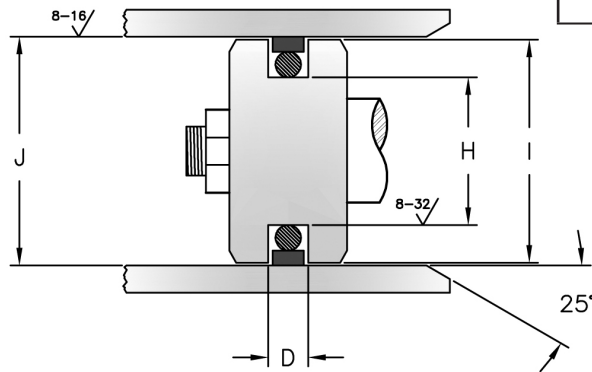
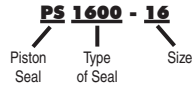

SEAL INFORMATION	
MATERIAL	15% GLASS FILLED PTFE SEAL RUBBER ENERGIZER
TEMPERATURE RANGE	-40° TO +220° F
PRESSURE RANGE	0 TO 5,000 PSI
SPEED	12 FT/SEC

PISTON SEAL ASSEMBLIES

Part Number	A Nom. ID	B Nom. OD	C Nom. Ht	D GROOVE WIDTH	H GROOVE DIAMETER	I PISTON DIAMETER	J BORE DIAMETER	C HEIGHT	CS ₁ RING CROSS SECTION	List Price
PS1600-16	.787	1	.088	.094 ±.003	.787 ±.002	.999 ^{+.000} _{-.003}	1.000 ^{+.002} _{+.000}	.088 ±.005	.055 ±.005	\$6.73
PS1600-18	.912	1-1/8	.088	.094 ±.003	.912 ±.002	1.124 ^{+.000} _{-.003}	1.125 ^{+.002} _{+.000}	.088 ±.005	.055 ±.005	6.88
PS1600-20	1.037	1-1/4	.088	.094 ±.003	1.037 ±.002	1.249 ^{+.000} _{-.003}	1.250 ^{+.002} _{+.000}	.088 ±.005	.055 ±.005	7.06
PS1600-22	1.162	1-3/8	.088	.094 ±.003	1.162 ±.002	1.374 ^{+.000} _{-.003}	1.375 ^{+.002} _{+.000}	.088 ±.005	.055 ±.005	7.18
PS1600-24	1.287	1-1/2	.088	.094 ±.003	1.287 ±.002	1.499 ^{+.000} _{-.003}	1.500 ^{+.002} _{+.000}	.088 ±.005	.055 ±.005	7.39
PS1600-26	1.412	1-5/8	.088	.094 ±.003	1.412 ±.002	1.624 ^{+.000} _{-.003}	1.625 ^{+.002} _{+.000}	.088 ±.005	.055 ±.005	7.63
PS1600-28	1.537	1-3/4	.088	.094 ±.003	1.537 ±.002	1.749 ^{+.000} _{-.003}	1.750 ^{+.002} _{+.000}	.088 ±.005	.055 ±.005	8.34
PS1600-30	1.598	1-7/8	.12	.126 ±.003	1.598 ±.002	1.874 ^{+.000} _{-.003}	1.875 ^{+.002} _{+.000}	.120 ±.005	.060 ±.005	8.60
PS1600-32	1.723	2	.12	.126 ±.003	1.723 ±.002	1.999 ^{+.000} _{-.003}	2.000 ^{+.002} _{+.000}	.120 ±.005	.060 ±.005	9.30
PS1600-36	1.973	2-1/4	.12	.126 ±.003	1.973 ±.002	2.249 ^{+.000} _{-.003}	2.250 ^{+.002} _{+.000}	.120 ±.005	.060 ±.005	9.89
PS1600-38	2.098	2-3/8	.12	.126 ±.003	2.098 ±.002	2.374 ^{+.000} _{-.003}	2.375 ^{+.002} _{+.000}	.120 ±.005	.060 ±.005	10.35
PS1600-40	2.223	2-1/2	.12	.126 ±.003	2.223 ±.002	2.500 ^{+.000} _{-.003}	2.500 ^{+.002} _{+.000}	.120 ±.005	.060 ±.005	10.35
PS1600-44	2.353	2-3/4	.15	.157 ±.003	2.353 ±.002	2.750 ^{+.000} _{-.004}	2.750 ^{+.002} _{+.000}	.150 ±.005	.090 ±.005	12.36
PS1600-48	2.603	3	.15	.157 ±.003	2.603 ±.002	3.000 ^{+.000} _{-.004}	3.000 ^{+.002} _{+.000}	.150 ±.005	.090 ±.005	15.93
PS1600-52	2.853	3-1/4	.15	.157 ±.003	2.853 ±.002	3.250 ^{+.000} _{-.004}	3.250 ^{+.002} _{+.000}	.150 ±.005	.090 ±.005	16.79

STYLE PS1600 GLASS FILLED PTFE PISTON SEALS

Part Number	A Nom. ID	B Nom. OD	C Nom. Ht	D GROOVE WIDTH	H GROOVE DIAMETER	I PISTON DIAMETER	J BORE DIAMETER	C HEIGHT	CS ₁ RING CROSS SECTION	List Price
PS1600-56	3.103	3-1/2	.15	.157 ±.003	3.103 ±.002	3.500 ^{+.000} _{-.004}	3.500 ^{+.002} _{+.000}	.150 ±.005	.090 ±.005	17.29
PS1600-60	3.353	3-3/4	.15	.157 ±.003	3.353 ±.002	3.749 ^{+.000} _{-.004}	3.750 ^{+.002} _{+.000}	.150 ±.005	.090 ±.005	17.39
PS1600-64	3.603	4	.15	.157 ±.003	3.603 ±.002	4.000 ^{+.000} _{-.004}	4.000 ^{+.002} _{+.000}	.150 ±.005	.090 ±.005	17.77
PS1600-68	3.853	4-1/4	.15	.157 ±.003	3.853 ±.002	4.250 ^{+.000} _{-.004}	4.250 ^{+.002} _{+.000}	.150 ±.005	.090 ±.005	17.72
PS1600-72	4.103	4-1/2	.15	.157 ±.003	4.103 ±.002	4.500 ^{+.000} _{-.004}	4.500 ^{+.002} _{+.000}	.150 ±.005	.090 ±.005	17.94
PS1600-76	4.353	4-3/4	.15	.157 ±.003	4.353 ±.002	4.750 ^{+.000} _{-.004}	4.750 ^{+.002} _{+.000}	.150 ±.005	.090 ±.005	21.87
PS1600-80	4.603	5	.15	.157 ±.003	4.603 ±.002	5.000 ^{+.000} _{-.004}	5.000 ^{+.002} _{+.000}	.150 ±.005	.090 ±.005	22.25
PS1600-84	4.853	5-1/4	.15	.157 ±.003	4.853 ±.002	5.250 ^{+.000} _{-.004}	5.250 ^{+.002} _{+.000}	.150 ±.005	.090 ±.005	23.77
PS1600-88	5.103	5-1/2	.15	.157 ±.003	5.103 ±.002	5.500 ^{+.000} _{-.004}	5.500 ^{+.002} _{+.000}	.150 ±.005	.090 ±.005	25.21
PS1600-92	5.353	5-3/4	.15	.157 ±.003	5.353 ±.002	5.750 ^{+.000} _{-.004}	5.750 ^{+.002} _{+.000}	.150 ±.005	.090 ±.005	30.85
PS1600-96	5.305	6	.287	.293 ±.003	5.305 ±.002	6.000 ^{+.000} _{-.005}	6.000 ^{+.002} _{+.000}	.287 ±.005	.120 ±.005	35.01
PS1600-112	6.305	7	.287	.293 ±.003	6.305 ±.002	7.000 ^{+.000} _{-.005}	7.000 ^{+.002} _{+.000}	.287 ±.005	.120 ±.005	53.09