

STYLE MYR BUFFER SEALS

Molded in urethane and employing a back-up, this seal absorbs the shock of pressure spikes to protect the rod seal. The unique design relieves back pressure between the buffer and the rod seal.

NOTE: ME = Merkel Equivalent.

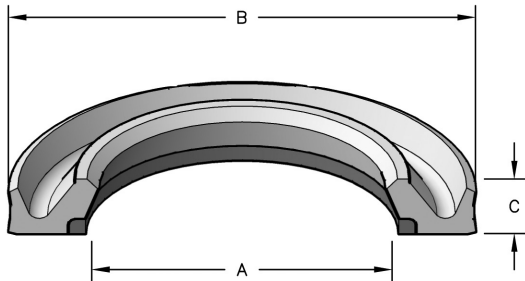

HERCULES PART NUMBERS

MYR - 40 X 50.7 X 3.9

Type of Seal Inside Diameter Housing Diameter Height

SEAL INFORMATION	
MATERIAL	URETHANE BUFFER NYLON BACK-UP
TEMPERATURE RANGE	-30° TO +220° F
PRESSURE RANGE	0 TO 7,000 PSI
SPEED	3 FT/SEC

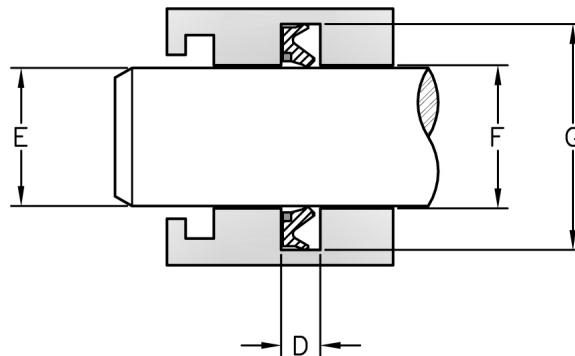

BUFFER SEALS

Part Number	A Nom. ID	B Nom. OD	C Nom. Ht	D GROOVE WIDTH	E ROD DIAMETER	F THROAT DIAMETER	G HOUSING DIAMETER	List Price
MYR-40X50.7X3.9	40	50.7	3.9	4.20 +0.20 +0.00	40.00 -0.025 -0.064	40.00 +0.062 +0.000	50.70 +0.20 +0.00	\$51.61
MYR-40X55.1X5.9-ME	40	55	5.9	6.30 +0.20 +0.00	40.00 -0.025 -0.064	40.00 +0.062 +0.000	55.00 +0.074 +0.000	29.30
MYR-40X55.5X5.9	40	55.5	5.9	6.30 +0.20 +0.00	40.00 -0.025 -0.064	40.00 +0.062 +0.000	55.50 +0.20 +0.00	10.24
MYR-45X55.7X3.9	45	55.7	3.9	4.20 +0.20 +0.00	45.00 -0.025 -0.064	45.00 +0.062 +0.000	55.70 +0.20 +0.00	56.36
MYR-45X60.1X5.9-ME	45	60.1	5.9	6.30 +0.20 +0.00	45.00 -0.025 -0.064	45.00 +0.062 +0.000	60.10 +0.074 +0.000	29.59
MYR-45X60.5X5.9	45	60.5	5.9	6.30 +0.20 +0.00	45.00 -0.025 -0.064	45.00 +0.062 +0.000	60.50 +0.20 +0.00	10.82
MYR-50X62.9X3.6	50	62.9	3.6	3.60 +0.20 +0.00	50.00 -0.025 -0.064	50.00 +0.062 +0.000	62.90 +0.20 +0.00	31.77
MYR-50X65.1X5.9-ME	50	65.1	5.9	6.30 +0.20 +0.00	50.00 -0.025 -0.064	50.00 +0.062 +0.000	65.10 +0.074 +0.000	31.09
MYR-50X65.5X5.9	50	65.5	5.9	6.30 +0.20 +0.00	50.00 -0.025 -0.064	50.00 +0.062 +0.000	65.50 +0.20 +0.00	20.86
MYR-55X70.1X5.9-ME	55	70.1	5.9	6.30 +0.20 +0.00	55.00 -0.030 +0.924	55.00 +0.074 +0.000	70.10 +0.074 +0.000	33.54
MYR-55X70.5X5.9	55	70.5	5.9	6.30 +0.20 +0.00	55.00 -0.030 -0.076	55.00 +0.074 +0.000	70.50 +0.20 +0.00	20.98
MYR-56X71.1X5.9-ME	56	71.1	5.9	6.30 +0.20 +0.00	56.00 -0.030 -0.076	56.00 +0.074 +0.000	71.10 +0.074 +0.000	30.78
MYR-56X71.5X5.9	56	71.5	5.9	6.30 +0.20 +0.00	56.00 -0.030 -0.076	56.00 +0.074 +0.000	71.50 +0.20 +0.00	36.08
MYR-60X75.1X5.9-ME	60	75.1	5.9	6.30 +0.20 +0.00	60.00 -0.030 -0.076	60.00 +0.074 +0.000	75.10 +0.074 +0.000	33.87
MYR-60X75.5X5.9	60	75.5	5.9	6.30 +0.20 +0.00	60.00 -0.030 -0.076	60.00 +0.074 +0.000	75.50 +0.20 +0.00	29.80

STYLE MYR BUFFER SEALS

BUFFER SEALS

Part Number	A Nom. ID	B Nom. OD	C Nom. Ht	D GROOVE WIDTH	E ROD DIAMETER	F THROAT DIAMETER	G HOUSING DIAMETER	List Price
MYR-63X78.1X5.9	63	78.1	5.9	6.30 +0.20 +0.00	63.00 -0.030 -0.076	63.00 +0.074 +0.000	78.10 +0.074 +0.000	29.33
MYR-63X78.1X5.9-ME	63	78.1	5.9	6.30 +0.20 +0.00	63.00 -0.030 -0.076	63.00 +0.074 +0.000	78.10 +0.074 +0.000	33.87
MYR-63X78.5X5.9	63	78.5	5.9	6.30 +0.20 +0.00	63.00 -0.030 -0.076	63.00 +0.074 +0.000	78.50 +0.20 +0.00	23.34
MYR-65X80.5X5.9	65	80.5	5.9	6.30 +0.20 +0.00	65.00 -0.030 -0.076	65.00 +0.074 +0.000	80.50 +0.20 +0.00	35.44
MYR-70X85.1X5.9-ME	70	85.1	5.9	6.30 +0.20 +0.00	70.00 -0.030 -0.076	70.00 +0.074 +0.000	85.10 +0.087 +0.000	43.20
MYR-70X85.5X5.9	70	85.5	5.9	6.30 +0.20 +0.00	70.00 -0.030 -0.076	70.00 +0.074 +0.000	85.50 +0.20 +0.00	38.68
MYR-75X90.5X5.9	75	90.5	5.9	6.30 +0.20 +0.00	75.00 -0.030 -0.076	75.00 +0.074 +0.000	90.50 +0.20 +0.00	41.13
MYR-75X91.3X5.6	75	91.28	5.6	5.60 +0.20 +0.00	75.00 -0.030 -0.076	75.00 +0.074 +0.000	91.28 +0.20 +0.00	103.90
MYR-80X95.1X5.9-ME	80	95.1	5.9	6.30 +0.20 +0.00	80.00 -0.030 -0.076	80.00 +0.074 +0.000	95.10 +0.087 +0.000	51.09
MYR-80X95.5X5.9	80	95.5	5.9	6.30 +0.20 +0.00	80.00 -0.030 -0.076	80.00 +0.074 +0.000	95.50 +0.20 +0.00	43.55
MYR-80X96.3X5.6	80	96.28	5.6	5.60 +0.20 +0.00	80.00 -0.030 -0.076	80.00 +0.074 +0.000	96.28 +0.20 +0.00	106.51
MYR-85X100.5X5.9	85	100.5	5.9	6.30 +0.20 +0.00	85.00 -0.036 -0.090	85.00 +0.087 +0.000	100.50 +0.20 +0.00	46.73
MYR-90X105.5X5.9	90	105.5	5.9	6.30 +0.20 +0.00	90.00 -0.036 -0.090	90.00 +0.087 +0.000	105.50 +0.20 +0.00	56.41
MYR-95X110.5X5.9	95	110.5	5.9	6.30 +0.20 +0.00	95.00 -0.036 -0.090	95.00 +0.087 +0.000	110.50 +0.20 +0.00	59.55
MYR-100X115.5X5.9	100	115.5	5.9	6.30 +0.20 +0.00	100.00 -0.036 -0.090	100.00 +0.087 +0.000	115.50 +0.20 +0.00	61.27
MYR-105X120.5X5.9	105	120.5	5.9	6.30 +0.20 +0.00	105.00 -0.036 -0.090	105.00 +0.087 +0.000	120.50 +0.20 +0.00	63.48
MYR-110X125.5X5.9	110	125.5	5.9	6.30 +0.20 +0.00	110.00 -0.036 -0.090	110.00 +0.087 +0.000	125.50 +0.20 +0.00	66.10
MYR-115X130.5X5.9	115	130.5	5.9	6.30 +0.20 +0.00	115.00 -0.036 -0.090	115.00 +0.087 +0.000	130.50 +0.20 +0.00	36.46
MYR-120X135.5X5.9	120	135.5	5.9	6.30 +0.20 +0.00	120.00 -0.036 -0.090	120.00 +0.087 +0.000	135.50 +0.20 +0.00	71.76
MYR-125X140.5X5.9	125	140.5	5.9	6.30 +0.20 +0.00	125.00 -0.043 -0.106	125.00 +0.10 +0.00	140.50 +0.20 +0.00	36.04
MYR-130X145.5X5.9	130	145.5	5.9	6.30 +0.20 +0.00	130.00 -0.043 -0.106	130.00 +0.10 +0.00	145.50 +0.20 +0.00	111.37
MYR-140X155.5X5.9	140	155.5	5.9	6.30 +0.20 +0.00	140.00 -0.043 -0.106	140.00 +0.10 +0.00	155.50 +0.20 +0.00	181.37
MYR-150X165.5X5.9	150	165.5	5.9	6.30 +0.20 +0.00	150.00 -0.043 -0.106	150.00 +0.10 +0.00	165.50 +0.20 +0.00	118.88
MYR-155X170.5X5.9	155	170.5	5.9	6.30 +0.20 +0.00	155.00 -0.043 -0.106	155.00 +0.10 +0.00	170.50 +0.20 +0.00	121.74
MYR-160X175.5X5.9	160	175.5	5.9	6.30 +0.20 +0.00	160.00 -0.043 -0.106	160.00 +0.10 +0.00	175.50 +0.20 +0.00	182.28
MYR-165X180.5X5.9	165	180.5	5.9	6.30 +0.20 +0.00	165.00 -0.043 -0.106	165.00 +0.10 +0.00	180.50 +0.20 +0.00	194.03
MYR-170X185.5X5.9	170	185.5	5.9	6.30 +0.20 +0.00	170.00 -0.043 -0.106	170.00 +0.10 +0.00	185.50 +0.20 +0.00	257.03
MYR-180X195.5X5.9	180	195.5	5.9	6.30 +0.20 +0.00	180.00 -0.043 -0.106	180.00 +0.10 +0.00	195.50 +0.20 +0.00	358.70
MYR-190X205.5X5.9	190	205.5	5.9	6.30 +0.20 +0.00	190.00 -0.050 -0.122	190.00 +0.115 +0.000	205.50 +0.20 +0.00	202.24