

WELD COUPLINGS



866-FLANGES | 513.527.4444 | Fax 513.527.4449
sales@anchorfluidpower.com | anchorfluidpower.com

SAE Full Couplings	50
SAE Half Couplings	51
NPTF Full Couplings	52
NPTF Half Couplings	53
BSPP Full Couplings	54
BSPP Half Couplings	55
ISO 6149 Metric Couplings	56
Socket Weld Couplings	57
90 Degree Wed Couplings	58

SAE Full Couplings

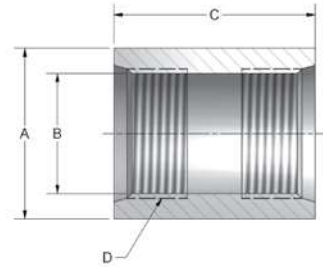
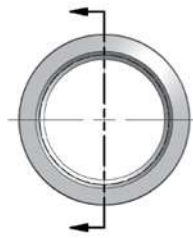

- AISI1020 Carbon Steel
- 316L Stainless Steel
- Includes individual thread identification marking
- Additional thread sizes and configurations available

SAE TO SAE FULL COUPLING					
CARBON STEEL PART NO.	STAINLESS STEEL PART NO.	A	B	C	D SAE UN-2B
830-4	830-4-SS	0.88	0.39	1.16	*7/16-20
830-6	830-6-SS	1.00	.509	1.25	*9/16-18
830-8	830-8-SS	1.25	.689	1.63	*3/4-16
830-10	830-10-SS	1.38	.806	1.50	*7/8-14
830-12	830-12-SS	1.50	.981	2.06	1 1/16-12
830-14	830-14-SS	1.63	1.106	2.00	1 3/16-12
830-16	830-16-SS	1.75	1.231	2.06	1 5/8-12
830-20	830-20-SS	2.25	1.544	2.06	1 5/8-12
830-24	830-24-SS	2.75	1.794	2.20	1 7/8-12
830-32	830-32-SS	3.25	2.419	2.50	2 1/2-12
830-40	830-40-SS	3.75	2.92	3.00	3-12
830-48	830-48-SS	4.40	3.42	3.00	3 1/2-12
830-64	830-64-SS	5.25	4.42	3.25	4 1/2-12

*UNF-2B

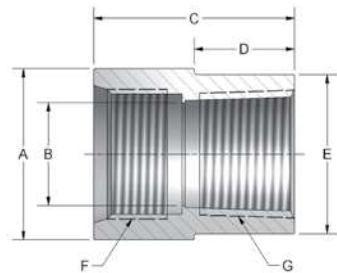
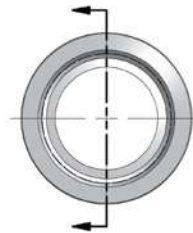

- AISI1020 Carbon Steel
- 316L Stainless Steel
- Includes individual thread identification marking
- Additional thread sizes and configurations available

SAE TO NPTF FULL COUPLING								
CARBON STEEL PART NO.	STAINLESS STEEL PART NO.	A	B	C	D	E	F SAE UN-2B	G NPTF
825-4	825-4-SS	1.00	.389	1.27	.64	.875	*7/16-20	1/4-18
825-6	825-6-SS	1.13	.508	1.50	.75	1.000	*9/16-18	3/8-18
825-8	825-8-SS	1.25	.650	1.63	.82	1.125	*3/4-16	1/2-14
825-10-12	825-10-12-SS	1.50	.806	1.75	.88	1.375	*7/8-14	3/4-14
825-12	825-12-SS	1.50	.850	2.06	1.03	1.375	1 1/16-12	3/4-14
825-14-16	825-14-16-SS	1.75	1.050	2.15	1.08	1.625	1 3/16-12	1-11.5
825-16	825-16-SS	1.75	1.050	2.06	1.03	1.625	1 5/16-12	1-11.5
825-20	825-20-SS	2.25	1.420	2.06	1.03	2.125	1 5/8-12	1 1/4-11.5
825-24	825-24-SS	2.75	1.650	2.20	1.10	2.500	1 7/8-12	1 1/2-11.5
825-32	825-32-SS	3.25	2.125	2.50	1.25	3.000	2 1/2-12	2-11.5
825-40	825-40-SS	3.75	2.38	3.00	1.50	3.50	3-2	2 1/2-8
825-48	825-48-SS	4.40	3.00	3.00	1.50	4.00	3 1/2-12	3-8
825-64	825-64-SS	5.25	4.00	3.25	1.63	5.00	4 1/2-12	4-8

*UNF-2B



SAE Half Couplings

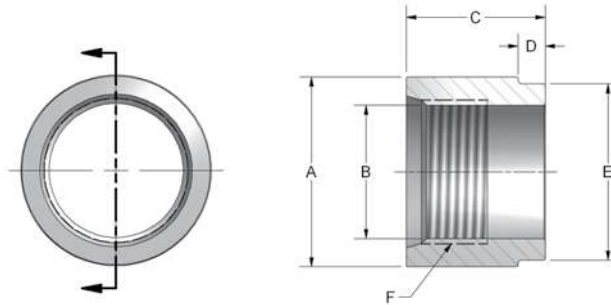

- AISI1020 Carbon Steel
- 316L Stainless Steel
- Includes individual thread identification marking
- Additional thread sizes and configurations available

SAE HALF COUPLING							
CARBON STEEL PART NO.	STAINLESS STEEL PART NO.	A	B	C	D	E	F SAE UN-2B
835-4	835-4-SS	.88	.389	1.00	.250	.750	*7/16-20
835-6	835-6-SS	1.00	.509	1.00	.250	.875	*9/16-18
835-8	835-8-SS	1.25	.689	1.06	.250	1.125	*3/4-16
835-10	835-10-SS	1.38	.806	1.06	.250	1.250	*7/8-14
835-12	835-12-SS	1.50	.981	1.28	.250	1.375	1 1/16-12
835-14	835-14-SS	1.63	1.106	1.25	.250	1.500	1 3/16-12
835-16	835-16-SS	1.75	1.231	1.28	.250	1.625	1 5/16-12
835-20	835-20-SS	2.25	1.544	1.28	.250	2.125	1 5/8-12
835-24	835-24-SS	2.75	1.794	1.28	.250	2.500	1 7/8-12
835-32	835-32-SS	3.25	2.419	1.50	.250	3.000	2 1/2-12
835-40	835-40-SS	3.75	2.92	2.00	.250	3.500	3-12
835-48	835-48-SS	4.40	3.42	2.25	.250	4.000	3 1/2-12
835-64	835-64-SS	5.25	4.42	2.25	.250	5.000	4 1/2-12

*UNF-2B

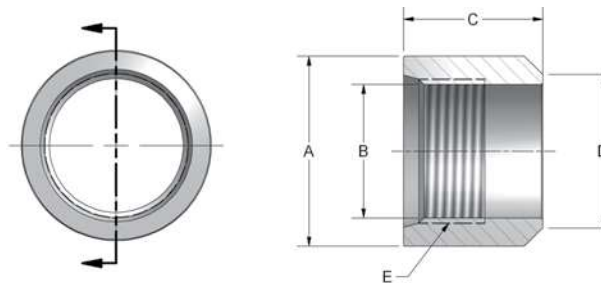

- AISI1020 Carbon Steel
- 316L Stainless Steel
- Includes individual thread identification marking
- Additional thread sizes and configurations available

SAE HALF COUPLING BEVEL						
CARBON STEEL PART NO.	STAINLESS STEEL PART NO.	A	B	C	D	E SAE UN-2B
835B-4	835B-4-SS	.88	.389	1.00	.570	*7/16-20
835B-6	835B-6-SS	1.00	.509	1.00	.690	*9/16-18
835B-8	835B-8-SS	1.25	.689	1.06	.870	*3/4-16
835B-10	835B-10-SS	1.38	.806	1.06	.990	*7/8-14
835B-12	835B-12-SS	1.50	.981	1.28	1.160	1 1/16-12
835B-14	835B-14-SS	1.63	1.106	1.25	1.290	1 3/16-12
835B-16	835B-16-SS	1.75	1.231	1.28	1.410	1 5/16-12
835B-20	835B-20-SS	2.25	1.544	1.28	1.720	1 5/8-12
835B-24	835B-24-SS	2.75	1.794	1.28	1.980	1 7/8-12
835B-32	835B-32-SS	3.25	2.419	1.50	2.600	2 1/2-12
835B-40	835B-40-SS	3.75	2.92	2.00	3.000	3-12
835B-48	835B-48-SS	4.40	3.42	2.25	3.500	3 1/2-12
835B-64	835B-64-SS	5.25	4.42	2.25	4.500	4 1/2-12

*UNF-2B

NPTF Full Couplings

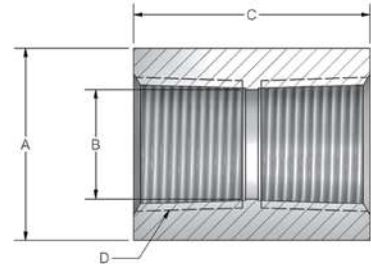
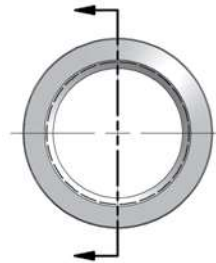

- AISI1020 Carbon Steel
- 316L Stainless Steel
- Includes individual thread identification marking
- Additional thread sizes and configurations available

NPTF TO NPTF FULL COUPLING					
CARBON STEEL PART NO.	STAINLESS STEEL PART NO.	A	B	C	D NPTF
865-4	865-4-SS	.88	.391	1.25	1/4-18
865-6	865-6-SS	1.00	.520	1.50	3/8-18
865-8	865-8-SS	1.25	.650	1.85	1/2-14
865-12	865-12-SS	1.50	.850	1.85	3/4-14
865-16	865-16-SS	1.75	1.050	2.35	1-11.5
865-20	865-20-SS	2.25	1.420	2.35	1 1/4-11.5
865-24	865-24-SS	2.75	1.560	2.35	1 1/2-11.5
865-32	865-32-SS	3.25	2.125	2.35	2-11.5



NPTF Half Couplings

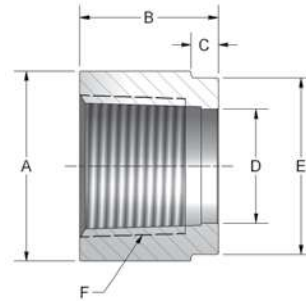
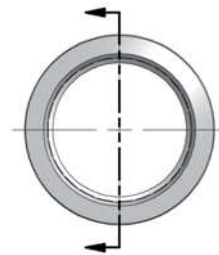

- AISI1020 Carbon Steel
- 316L Stainless Steel
- Includes individual thread identification marking
- Additional thread sizes and configurations available

NPTF HALF COUPLING							
CARBON STEEL PART NO.	STAINLESS STEEL PART NO.	A	B	C	D	E	F NPTF
845-4	845-4-SS	.88	1.06	.250	.391	.750	1/4-18
845-6	845-6-SS	1.00	1.00	.250	.563	.875	3/8-18
845-8	845-8-SS	1.25	1.06	.250	.650	1.125	1/2-14
845-12	845-12-SS	1.50	1.28	.250	.850	1.375	3/4-14
845-16	845-16-SS	1.75	1.28	.250	1.050	1.625	1-11.5
845-20	845-20-SS	2.25	1.28	.250	1.420	2.125	1 1/4-11.5
845-24	845-24-SS	2.75	1.28	.250	1.560	2.500	1 1/2-11.5
845-32	845-32-SS	3.25	1.50	.250	2.125	3.000	2-11.5
845-40	845-40-SS	3.75	2.00	.250	2.500	3.500	2 1/2-8
845-48	845-48-SS	4.25	2.25	.250	3.000	4.000	3-8
845-64	845-64-SS	5.25	2.25	.250	4.000	5.000	4-8

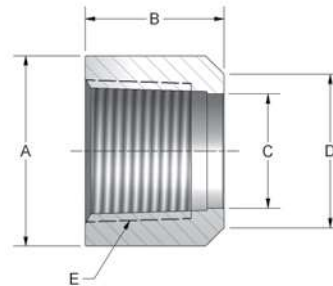
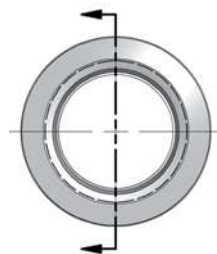

- AISI1020 Carbon Steel
- 316L Stainless Steel
- Includes individual thread identification marking
- Additional thread sizes and configurations available

NPTF HALF COUPLING BEVEL						
CARBON STEEL PART NO.	STAINLESS STEEL PART NO.	A	B	C	D	E NPTF
845B-4	845B-4-SS	.88	1.06	.391	.570	1/4-18
845B-6	845B-6-SS	1.00	1.00	.520	.690	3/8-18
845B-8	845B-8-SS	1.25	1.06	.650	.870	1/2-14
845B-12	845B-12-SS	1.50	1.28	.850	1.160	3/4-14
845B-16	845B-16-SS	1.75	1.28	1.050	1.410	1-11.5
845B-20	845B-20-SS	2.25	1.28	1.420	1.720	1 1/4-11.5
845B-24	845B-24-SS	2.75	1.28	1.560	1.980	1 1/2-11.5
845B-32	845B-32-SS	3.25	1.50	2.125	2.600	2-11.5
845B-40	845B-40-SS	3.75	2.00	2.500	3.100	2 1/2-8
845B-48	845B-48-SS	4.40	2.25	3.000	3.600	3-8
845B-64	845B-64-SS	5.25	2.25	4.000	4.450	4-8

BSPP Full Couplings

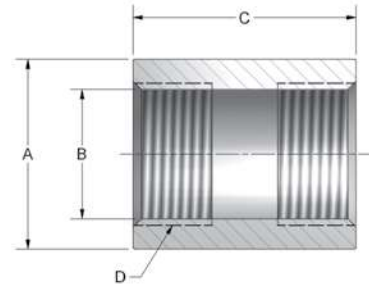
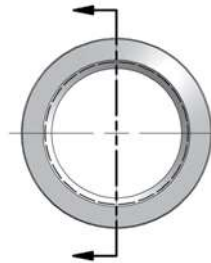

- AISI1020 Carbon Steel
- 316L Stainless Steel
- Includes individual thread identification marking
- Additional thread sizes and configurations available

BSPP TO BSPP FULL COUPLING					
CARBON STEEL PART NO.	STAINLESS STEEL PART NO.	A	B	C	D BSPP
850-4	850-4-SS	.88	.451	1.25	1/4-19
850-6	850-6-SS	1.00	.589	1.25	3/8-19
850-8	850-8-SS	1.25	.734	1.63	1/2-14
850-12	850-12-SS	1.50	.949	2.06	3/4-14
850-16	850-16-SS	1.75	1.193	2.06	1-11
850-20	850-20-SS	2.25	1.534	2.06	1 1/4-11
850-24	850-24-SS	2.75	1.766	2.20	1 1/2-11
850-32	850-32-SS	3.25	2.231	2.50	2-11

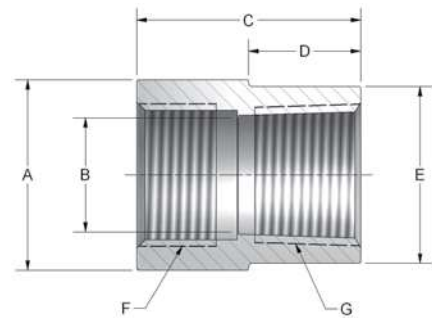
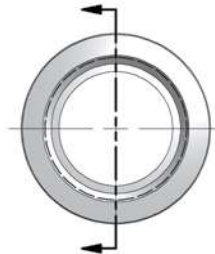

- AISI1020 Carbon Steel
- 316L Stainless Steel
- Includes individual thread identification marking
- Additional thread sizes and configurations available

BSPP TO NPTF FULL COUPLING								
CARBON STEEL PART NO.	STAINLESS STEEL PART NO.	A	B	C	D	E	F BSPP	G NPTF
860-4	860-4-SS	1.00	.408	1.27	.64	.875	1/4-19	1/4-18
860-6	860-6-SS	1.13	.507	1.50	.75	1.000	3/8-19	3/8-18
860-8	860-8-SS	1.25	.650	1.63	.82	1.125	1/2-14	1/2-14
860-12	860-12-SS	1.50	.850	2.06	1.03	1.375	3/4-14	3/4-14
860-16	860-16-SS	1.75	1.000	2.06	1.03	1.625	1-11	1-11.5
860-20	860-20-SS	2.25	1.450	2.06	1.03	2.125	1 1/4-11	1 1/4-11.5
860-24	860-24-SS	2.75	1.681	2.20	1.10	2.500	1 1/2-11	1 1/2-11.5
860-32	860-32-SS	3.25	2.125	2.50	1.25	3.000	2-11	2-11.5



BSPP Half Couplings

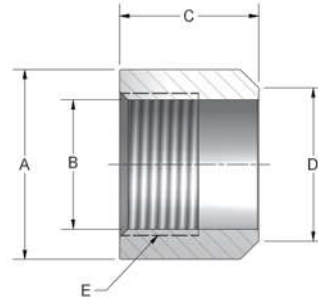
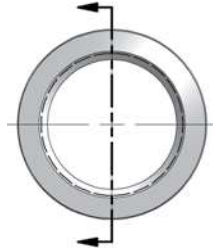

- AISI1020 Carbon Steel
- 316L Stainless Steel
- Includes individual thread identification marking
- Additional thread sizes and configurations available

BSPP HALF COUPLING BEVEL						
CARBON STEEL PART NO.	STAINLESS STEEL PART NO.	A	B	C	D	E BSPP
855B-4	855B-4-SS	.88	.451	1.00	.570	1/4-19
855B-6	855B-6-SS	1.00	.589	1.00	.690	3/8-19
855B-8	855B-8-SS	1.25	.734	1.06	.870	1/2-14
855B-12	855B-12-SS	1.50	.949	1.28	1.160	3/4-14
855B-16	855B-16-SS	1.75	1.193	1.28	1.410	1-11
855B-20	855B-20-SS	2.25	1.534	1.28	1.720	1 1/4-11
855B-24	855B-24-SS	2.75	1.766	1.28	1.980	1 1/2-11
855B-32	855B-32-SS	3.25	2.231	1.50	2.600	2-11

FLOW NEEDLE & CHECK VALVES

HYDRAULIC BALL VALVES

WELD COUPLINGS

HPU SUCTION & RETURN CONNECTIONS

FLANGES CARBON STEEL

FLANGES STAINLESS STEEL

ISO 6149 Metric Couplings

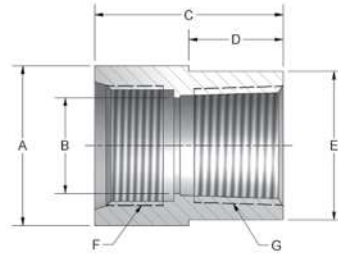
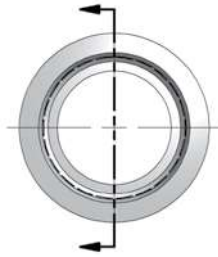

- AISI1020 Carbon Steel
- 316L Stainless Steel
- Includes individual thread identification marking
- Additional thread sizes and configurations available

ISO 6149 TO NPTF FULL COUPLING								
CARBON STEEL PART NO.	STAINLESS STEEL PART NO.	A	B	C	D	E	F ISO 6149 METRIC	G NPTF
885-M27-12	885-M27-12-SS	1.50	.850	2.06	1.03	1.375	M27 X 2	3/4-14
885-M33-16	885-M33-16-SS	1.75	1.050	2.06	1.03	1.625	M33 X 2	1-11,5
885-M42-20	885-M42-20-SS	2.25	1.420	2.06	1.03	2.125	M42 X 2	1 1/4-11,5
885-M48-24	885-M48-24-SS	2.75	1.650	2.20	1.10	2.500	M48 X 2	1 1/2-11,5
885-M60-32	885-M60-32-SS	3.25	2.125	2.50	1.25	3.000	M60 X 2	2-11,5

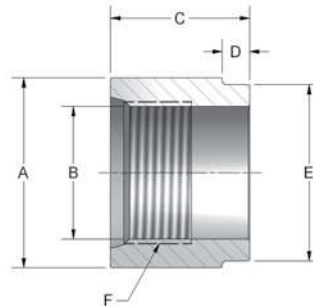
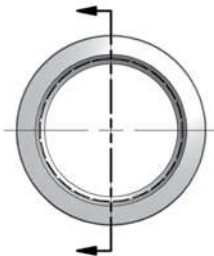

- AISI1020 Carbon Steel
- 316L Stainless Steel
- Includes individual thread identification marking
- Additional thread sizes and configurations available

ISO 6149 HALF COUPLING							
CARBON STEEL PART NO.	STAINLESS STEEL PART NO.	A	B	C	D	E	F ISO 6149 METRIC
880-M27	880-M27-SS	1.50	.981	1.28	.250	1.375	M27 X 2
880-M33	880-M33-SS	1.75	1.231	1.28	.250	1.625	M33 X 2
880-M42	880-M42-SS	2.25	1.544	1.28	.250	2.125	M42 X 2
880-M48	880-M48-SS	2.75	1.794	1.28	.250	2.500	M48 X 2
880-M60	880-M60-SS	3.25	2.419	1.50	.250	3.000	M60 X 2



Socket Weld Couplings

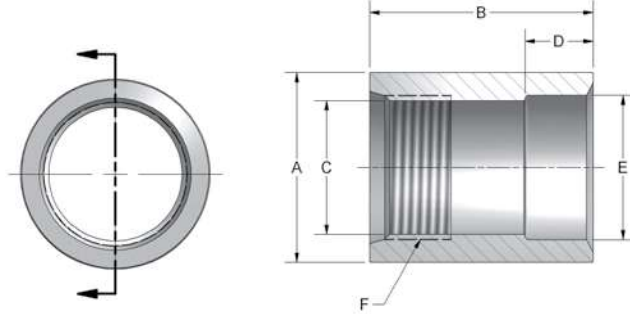

- AISI1020 Carbon Steel
- 316L Stainless Steel
- Includes individual thread identification marking
- Additional thread sizes and configurations available

SAE TO SOCKET WELD PIPE COUPLING							
CARBON STEEL PART NO.	STAINLESS STEEL PART NO.	A	B	C	D	E	F SAE UN-2B
820-8	820-8-SS	1.25	1.63	.689	.560	.855	*3/4-16
820-12	820-12-SS	1.50	2.06	.981	.560	1.062	1 1/16-12
820-16	820-16-SS	1.75	2.06	1.231	.630	1.328	1 5/16-12
820-20	820-20-SS	2.25	2.06	1.544	.690	1.672	1 5/8-12
820-24	820-24-SS	2.75	2.20	1.794	.750	1.922	1 7/8-12
820-32	820-32-SS	3.25	2.50	2.419	.875	2.406	2 1/2-12
820-40	820-40-SS	3.09	3.00	2.919	1.000	2.910	3-12
820-48	820-48-SS	3.59	3.00	3.419	1.120	3.550	3 1/2-12
820-64	820-64-SS	4.59	3.25	4.419	1.250	4.580	4 1/2-12

*UNF-2B

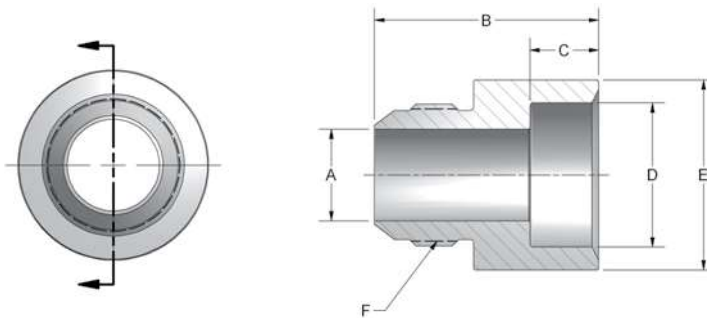

- AISI1020 Carbon Steel
- 316L Stainless Steel
- Includes individual thread identification marking
- Additional thread sizes and configurations available

SOCKET WELD PIPE TO MALE JIC COUPLING							
CARBON STEEL PART NO.	STAINLESS STEEL PART NO.	A	B	C	D	E	F THREAD
840-8	840-8-SS	.391	1.63	.560	.855	1.25	*3/4-16
840-12	840-12-SS	.609	1.89	.560	1.062	1.50	1 1/16-12
840-16	840-16-SS	.844	2.06	.630	1.328	1.75	1 5/16-12
840-20	840-20-SS	1.078	2.06	.690	1.672	2.25	1 5/8-12
840-24	840-24-SS	1.312	2.20	.750	1.922	2.75	1 7/8-12
840-32	840-32-SS	1.781	2.50	.875	2.406	3.25	2 1/2-12

*UNF-2A

90 Degree Weld Couplings

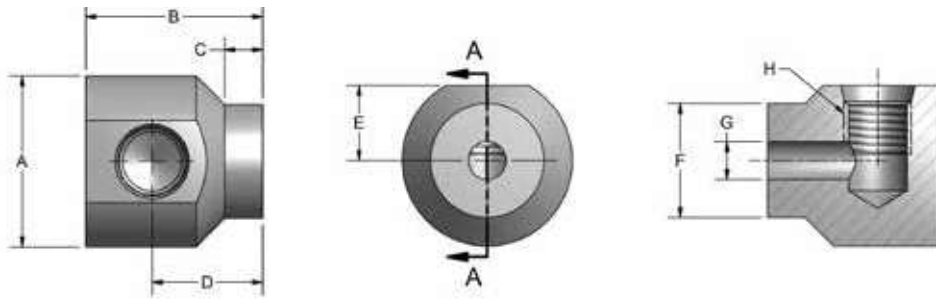

- AISI1020 Carbon Steel
- Includes individual thread identification marking
- Additional thread sizes and configurations available

SAE TO WELD 90 DEGREE COUPLING								
PART NUMBER	A	B	C	D	E	F	G	H SAE UN-2B
83590-4	1.13	1.17	0.250	0.729	0.493	0.750	0.250	7/16-20
83590-6	1.25	1.25	0.250	0.746	0.528	0.875	0.295	9/16-18
83590-8	1.75	1.53	0.250	0.907	0.646	1.125	0.394	3/4-16
83590-10	1.88	1.55	0.250	0.863	0.656	1.250	0.492	7/8-14
83590-12	2.25	2.05	0.375	1.305	0.784	1.375	0.630	1 1/16-12
83590-14	2.38	1.96	0.375	1.143	0.791	1.500	0.709	1 3/16-12
83590-16	2.63	2.32	0.375	1.449	0.890	1.625	0.827	1 5/16-12
83590-20	3.13	2.75	0.375	1.622	1.067	2.125	1.062	1 5/8-12
83590-24	3.63	3.31	0.500	1.939	1.284	2.500	1.300	1 7/8-12
83590-32	4.63	4.00	0.500	2.374	1.532	3.000	1.770	2 1/2-12

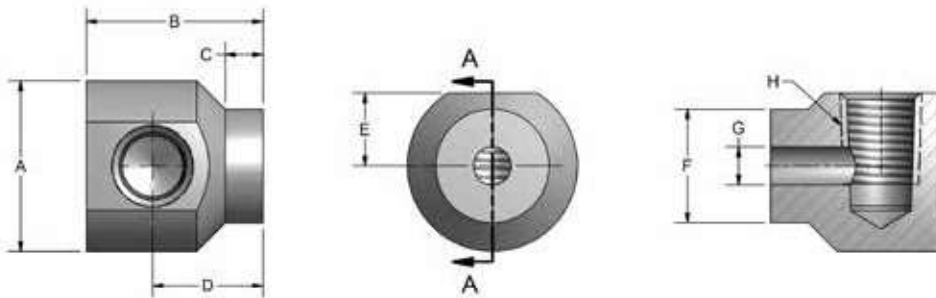

- AISI1020 Carbon Steel
- Includes individual thread identification marking
- Additional thread sizes and configurations available

NPTF TO WELD 90 DEGREE COUPLING								
PART NUMBER	A	B	C	D	E	F	G	H NPTF
84590-4	1.13	1.17	0.250	0.729	0.481	0.750	0.250	1/4-18
84590-6	1.25	1.25	0.250	0.746	0.488	0.875	0.295	3/8-18
84590-8	1.75	1.53	0.250	0.943	0.736	1.125	0.394	1/2-14
84590-12	2.25	2.05	0.375	1.305	0.965	1.375	0.630	3/4-14
84590-16	2.63	2.32	0.375	1.449	1.114	1.625	0.827	1-11.5
84590-20	3.13	2.75	0.375	1.605	1.299	2.125	1.062	1 1/4-11.5
84590-24	3.63	3.31	0.500	1.939	1.520	2.500	1.300	1 1/2-11.5
84590-32	4.63	4.00	0.500	2.374	1.961	3.000	1.770	2-11.5

